

Technical Bulletin

Number 186

February 20, 2007

Solaris Line 25M Gas Valve

When the Solaris line 25M 60 Hz (ADC P/N 128944) or 50 Hz (ADC P/N 128907) gas valve is shipped as a parts order it includes an orifice in the outlet burner tube hole (refer to photograph).

This orifice (#42) is for shipping purposes only and **MUST NOT BE USED!**

The dryer's original burner orifice should be used or a new orifice sized for the application (dryer model and type of heat).

If this incorrect orifice is used, in most cases, the BTUs will drastically be reduced and drying times extended.

If you are not sure what size orifice to use, contact ADC technical support with the dryer model, serial number and type of gas (i.e. natural or L.P.) to be used. If the location of the dryer is over 2,000 feet elevation, the technician should be made aware of that so the orifice is sized correctly.



Parts Price List

Our current Parts Price List (ADC P/N 451000) has a January 1, 2007 effective date, and is available to be downloaded for free from our web site, www.amdry.com. As with previous parts price lists, it's also available on our ADC Publications CD (ADC P/N 882206). Printed copies of the January 2007 Parts Price List is available through normal parts order channels at a net price of \$12.00 each.

The Parts Price List is updated on a quarterly basis: January, April, July, and October.

IMPORTANT

- \$ Prices are subject to change without notice. The prices on the invoice may not necessarily be the same as the prices shown on the Parts Price List.
- \$ Formal (written) quotes will be valid for thirty days. When submitting parts orders in which a formal quote was issued, the quotation number must be provided at the time or the quote will not be valid.
- \$ Verbal quotes are not binding and will not be honored.

Gray DSI Module and HV Wire Usage

All direct spark ignition module kits provided by ADC include a gray colored carbon high voltage wire. The use of this carbon HV wire is necessary in an effort to eliminate electrical noise (electrical interference) issues, which can cause both the microprocessor (computer control board) and the DSI module itself to operate erratically.

For all previously manufactured computer controlled (Phase 4.1, 5 and 6) models and current computer (Phase 7 and 8) controlled models, as well as past and present non-computer (single, dual timer or mechanical coin meter) controlled models, the gray carbon HV wire must be used when the dryer is converted to the gray DSI module!

**THE RED HIGH VOLTAGE WIRE MUST NOT BE USED
IN CONJUNCTION WITH ANY GRAY DSI MODULE!**



88 Currant Road
Fall River, MA
02720-4781
Telephone:
(508) 678-9000
Fax: (508) 678-9447

INSIDE

Emergency Stop Button Assembly Change	2	Returning Warranty Parts to ADC	5
Earlier Vintage Solaris Lint Screens	3	Lint Door/Hatch Change	6
Non-Coin Moisture Sensor Assembly Change ...	3	E-mail Registration Form	6
2007 Service School Schedule	3	ADC Publications CD	6
Control Board Cover Change	4	E-Mail Parts Order Shipment Notification	6
Soft Start Dip Switch Setting Change	4	Website Publications	6

For more information, visit our web site at www.amdry.com or email: techsupport@amdry.com

Emergency Stop Button Assembly Change

Models Affected: AD-758V, AD-120, AD-130, AD-145, AD-170, AD-175, AD-190, CG50, CG75, C178, STI-30, STI-54, STI-77 (50 Hz models only with E-Stop button).

Date Implemented: January 26, 2007

Nature of Change: E-Stop Push Pull Button Change

Due to compliant restrictions, manufacturer of the Emergency Stop has changed from an 800E series to an 800F series E-Stop button arrangement. As a result of this change, the related contact blocks have changed as well.

Below are the related front panel assemblies. The sheet metal panel itself has not changed, only the assembly has changed due to this E-Stop button arrangement change.

CHANGE FROM			CHANGE TO		
Qty.	P/N	Description	Qty.	P/N	Description
1	800564	ML-145/170 Dr Frt Assy E-Stop Sprinkler	1	802039	ML-145/170 Dr Frt Assy E-Stop Sprinkler
1	801627	ML-130 Magnet E-Stop Frt Panel Assy	1	802040	ML-130 Magnet E-Stop Frt Panel Assy
1	801637	ML-170 Magnet Frt Panel w/E-Stop Assy	1	802041	ML-170 Magnet Frt Panel w/E-Stop Assy
1	801639	ML-175 Magnet Frt Panel w/E-Stop Assy	1	802042	ML-175 Magnet Frt Panel w/E-Stop Assy
1	801641	ML-175 Mag S/S Frt Panel w/E-Stop Assy	1	802043	ML-175 Mag S/S Frt Panel w/E-Stop Assy
1	801645	ML-190 Magnet Frt Panel w/E-Stop Assy	1	802044	ML-190 Magnet Frt Panel w/E-Stop Assy
1	801647	ML-190 Mag S/S Frt Panel w/E-Stop Assy	1	802045	ML-190 Mag S/S Frt Panel w/E-Stop Assy
1	801651	ML-130,Sti-54 S/S Mag E-Stop Frt Pnl Assy	1	802046	ML-130,Sti-54 S/S Mag E-Stop Frt Pnl Assy
1	801653	ML-175 LH Mag Frt Pnl w/E-Stop Assy	1	802047	ML-175 LH Mag Frt Pnl w/E-Stop Assy
1	801730	ML-170 S/S Mag Frt Pnl w/E-Stop Assy	1	802048	ML-170 S/S Mag Frt Pnl w/E-Stop Assy
1	801731	ML-122,D120 Mag E-Stop Frt Pnl Assy	1	802049	ML-122,D120 Mag E-Stop Frt Pnl Assy
1	801901	Girbau,Sti-30 RH Mag Frt Pnl w/E-Stop Assy	1	802050	Girbau,Sti-30 RH Mag Frt Pnl w/E-Stop Assy
1	801905	CG75-85,Sti-30 S/S RH Mag Frt Pnl w/E-S	1	802051	CG75-85,Sti-30 S/S RH Mag Frt Pnl w/E-S
1	815933	170 V-Speed w/E-Stop Switch Assy	1	802052	170 V-Speed w/E-Stop Switch Assy
1	815965	AD-130 V-Speed E-Stop Switch Assy	1	802053	AD-130 V-Speed E-Stop Switch Assy
1	819079	ML-190 Dr Frt Assy w/E-Stop for Rd/Dr w/Sp	1	802054	ML-190 Dr Frt Assy w/E-Stop for Rd/Dr w/Sp
1	820297	120 HEPA S/S Dr Frt Assy Dr Interlock	1	802055	120 HEPA S/S Dr Frt Assy Dr Interlock
1	835342	ML-175 Dr Frt Assy w/E-Stop for Round Dr	1	802056	ML-175 Dr Frt Assy w/E-Stop for Round Dr
1	835357	ML-175 Dr Frt Assy w/E-Stop for Sprinkler	1	802057	ML-175 Dr Frt Assy w/E-Stop for Sprinkler
1	851565	CG50,75 PH8.3 OPL Ctrl Pnl Assy w/E-Stop	1	802058	CG50,75 PH8.3 OPL Ctrl Pnl Assy w/E-Stop
1	851569	CG50,75 PH8.3 Coin Ctrl Pnl Assy w/E-Stop	1	802059	CG50,75 PH8.3 Coin Ctrl Pnl Assy w/E-Stop
1	812986	AD-170 All Volt Sprinkler Control Pnl Assy	1	802060	AD-170 All Volt Sprinkler Control Pnl Assy
1	818310	MLG-190 Spkl Sys Ctrl Pnl Assy 460v 60 Hz	1	802061	MLG-190 Spkl Sys Ctrl Pnl Assy 460v 60 Hz
1	819945	ADG-120 Spkl Sys Ctrl Pnl 380-416v Fullce	1	802062	ADG-120 Spkl Sys Ctrl Pnl 380-416v Fullce
1	819988	AD-170 Spkl Control Pnl Assy 460v/3/3wr	1	802063	AD-170 Spkl Control Pnl Assy 460v/3/3wr
1	822713	ADG-170 Spkl System Ctrl Pnl 575v/3ph	1	802064	ADG-170 Spkl System Ctrl Pnl 575v/3ph
1	835347	MLG-175 Spkl System Ctrl Pnl 460/3/3/60	1	802065	MLG-175 Spkl System Ctrl Pnl 460/3/3/60
1	821900	AD-115/120HEPA S/S Delta P Assy w/Sw	1	802066	AD-115/120HEPA S/S Delta P Assy w/Sw

AD-120 and AD-170 Panel Assembly (800F Series Shown)

CHANGE FROM			CHANGE TO		
No.	P/N	Description	P/N	Description	
2	123500	Large Mushroom Head E-Stop Button Switch	123550	E-Stop Button Switch	
3	123506	Emergency Stop Nameplate	123506	Emergency Stop Nameplate	
4	123516	N.O. Contact Block	123566	N.O. Contact Block	
5	123521	N.C. Contact Block with Base	123751	N.C. Contact Block with Base	

AD-758V Panel Assembly Shown

CHANGE FROM			CHANGE TO		
No.	P/N	Description	P/N	Description	
7	123500	Large Mushroom Head E-Stop Button Switch	123550	E-Stop Button Switch	
8	123506	Emergency Stop Nameplate	123506	Emergency Stop Nameplate	
9	123520	N.O.-N.C. Contact Block	123570	N.O.-N.C. Contact Block	

Previous E-Stop Button (800E Series)

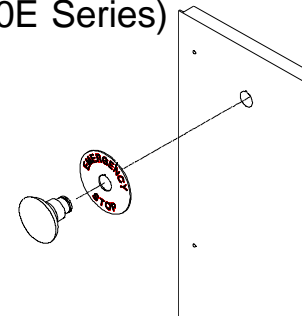

Current E-Stop Button (800F Series)

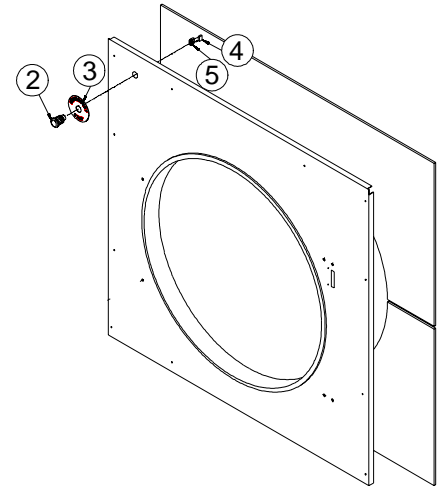

AD-758V Panel Assembly

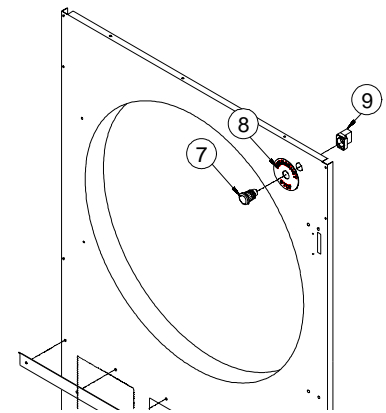

Comments: The current F and previously used E series E-Stop parts are not interchangeable. The nameplate is the only part that is. ADC still has a stock of the E series E-Stop parts available for replacement parts orders. Once these parts are gone, to convert to the F series, the E-Stop button switch and contact blocks must be changed as well. This also includes parts orders for the previous E series front panel assemblies listed.

Earlier Vintage Solaris Lint Screens

Earlier models of the SL20, SL2020, SL31 and SL3131 (and related OEMs) were manufactured with a finer/smaller mesh lint screen material, and secondary lint screen, which depending on the facilities installation, maintenance, and the use of "fabric softener sheets" can cause the primary lint screen to clog and be difficult to clean.

The more often the screen is cleaned, the easier it will be to maintain. If the screen is clogged, then it has to be removed and cleaned with soap and water, and scrubbed clean. This dirty or clogged lint screen will affect the drying times and efficiency of the dryer, and in some cases cause the dryer to shut down on a fault code.

For units in the field with this finer/smaller mesh lint screen, they can be upgraded to a different lint screen (304 stainless steel material) with larger holes, which will reduce the amount of maintenance to keep the screen clean. However, when this screen is used, the secondary lint screen must be removed, and in addition, a lint prevention device be added to the lint box blower assembly.

IMPORTANT: Failure to use this lint prevention device will cause premature component failure that will not be covered under warranty. If you're not sure if your dryers have this latest lint screen and lint prevention device, or if you require this lint screen upgrade and lint device, contact the ADC service department with the model and all serial numbers of the dryers in question.

NOTE: When the latest/upgrade lint screen and lint prevention device is used, the "secondary lint screen" must be removed.

Related OEMs: SLI-9, D20, CGS3040, SLI-14, MDG31, M31SL, CGS3131, MLG33 and M3131SL.

Phase 8 Non-Coin Moisture Sensor Assembly Change

Models Affected: Non-coin models SL50, SL75, CG2025, CGS3040, GS3131, CGS5060, CGS7585, MDG51, MDG77, SLI-23, and SLI-34

Date Implemented:
December 1, 2006

Nature of Change: Phase 8 non-coin moisture assembly (ADC P/N 819365) has been revised. Changes were made to front panel bulkhead where the moisture sensor mounting shim (ADC P/N 350264) is no longer required. (Illus. No. 2 in drawing.)

Comments: When replacing Phase 8 moisture sensor assembly (ADC P/N 819264) in the field, for models manufac-

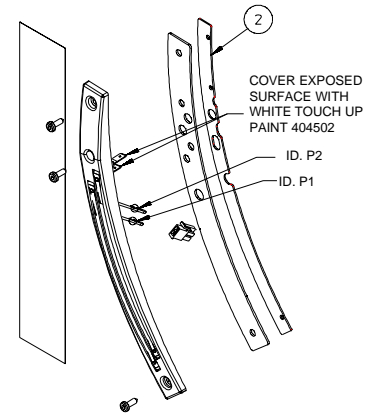

ured prior to this change, customer will have to use their old moisture sensor mounting shim, or purchase a new one (ADC P/N 350264) separately.

2007 Service School Schedule

ADC will be having six service schools at our modern facility in Fall River, Massachusetts during 2007

THE DATES ARE AS FOLLOWS:

DATE	TYPE OF SCHOOL	DESCRIPTION
April 19	Resellers/Dealers	Solaris Phase 8 Non-Coin and Coin
May 17	Coin Store Operators	Phase 7 and Phase 8 Solaris
June 14	Non-Coin End Users	Phase 7 and Phase 8 Solaris
September 6	Coin Store Operators	Phase 5 Models
October 11	Non-Coin End Users	Phase 5 and Phase 6 Models
November 15	Coin Store Operators	Phase 7 and Phase 8 (Not Solaris)

The fee for these one-day service schools is \$115 (NET) per school per person, is nonrefundable, and must be received by ADC no later than thirty days prior to the service school attendance date. ADC will limit the size of these schools to approximately ten people on a first-come, first-served basis. The fee covers the service school and lunch, plus manuals and writing materials. Any other expenses (all transportation costs, lodging, meals, etc.) are the responsibility of the individual attending the service school.

Being that over 90 percent of the dryers that leave the ADC factory are computerized, all service schools are microprocessor oriented. Due to time limitations, only the models quoted for the date noted will be covered. To assure that your specific model dryers will be covered at a particular service school session, ADC will require that your particular model numbers and serial numbers, and the type of controls be provided.

The resellers/dealers school will cover coin and non-coin computer programming, diagnostics and troubleshooting procedures, installation and start-up procedures, warranty information and procedures, new products etc.

The coin store operators school will cover coin computer programming, diagnostics and troubleshooting procedures, preventive maintenance etc.

The non-coin (end users) school (for facility engineers, maintenance technicians, at nursing homes, hotels etc.) will cover computer programming, diagnostics and troubleshooting procedures, etc.

Please contact Jeff Vieira by phone at (508) 678-9000 extension 145, by fax at (508) 678-9447, or by e-mail, Jvieira@amdry.com, if you wish to register or if you have questions concerning any aspect of our in-house service schools.

Phase 8.4 and Phase 8.2 Control Board Cover Change

Models Affected: SL2020, SL2929, SL3131, CGS3131, SLI-14

Date Implemented: November 16, 2006

Nature of Change: The Phase 8.4 (8.2) control board cover (Illus. No. 1 in drawing) has been redesigned in an effort in standardization, so one cover can be used for various applications.

Control Board Cover

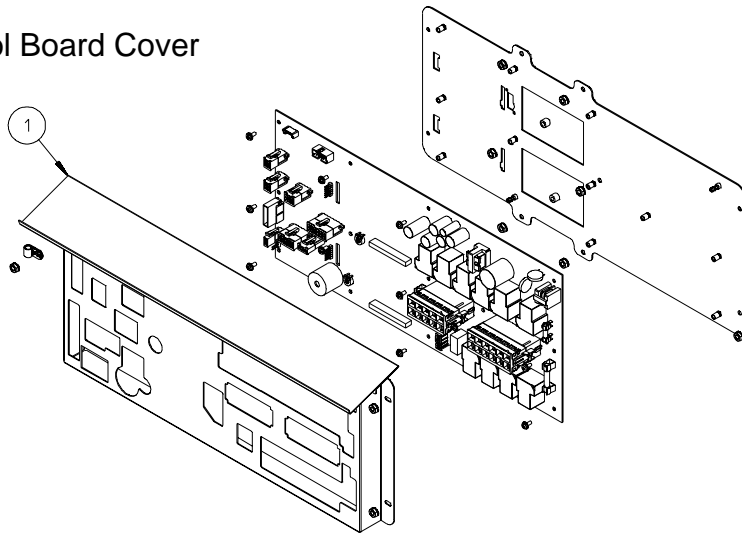

CHANGE FROM			CHANGE TO		
Qty.	P/N	Description	Qty.	P/N	Description
1	319187	Phase 8.4 Control Board Cover	1	319009	Solaris Control Board Cover
PSFs or assembly numbers affected by this change					
818899 – SL2020, SL2929 PH8.4 Coin Control Panel			819719 – SL2020, SL2929 PH8.4 Coin S/S Control Panel		
819326 – SL2020, SL2929 PH8.4 Non-Coin Control Panel			819587 – SL2020, SL2929 PH8.4 Non-Coin Control Panel		
CHANGE FROM			CHANGE TO		
Qty.	P/N	Description	Qty.	P/N	Description
1	319333	MLG33 Phase 8.2 Control Board Cover	1	319009	Solaris Control Board Cover
Assembly number affected by this change					
819310 – SL3131 Maytag PH8.225 Cent Control Door Assembly					
CHANGE FROM			CHANGE TO		
Qty.	P/N	Description	Qty.	P/N	Description
1	319337	ADC Phase 8.4 Control Board Cover	1	319009	Solaris Control Board Cover
PSFs or assembly numbers affected by this change					
819504 – SL3131 ADC PH8.4 25 Cent Coin Control Door Assy			819625 – SL3131 PH8.4 Euro GBP Prg Cntrl Panel Assy		
819514 – SL3131 JLA PH8.4 Coin Prg Eur GBP CE Cntrl Dr			819630 – SL3131 ADC PH8.4 Central Pay Cntrl Dr Assy		
819524 – SL3131 ADC PH8.4 Debit Card Control Door Assy			819696 – SL3131 PH8.4 Korean Prg Cntrl Pnl Assy		
819529 – SL3131 ADC PH8.4 Easy Debit Card Cntrl Pnl Assy			819812 – SL3131 ADC PH8.4 100 Yen Coin Cntrl Dr Assy		
818908 – SL3131 PH8.4 USA,CAD,JAPTWD Prg Cntrl Pnl Assy			819502 – SL3131 ESD PH8.4 Control Door Assy		
819608 – SL3131 ADC PH8.4 OPL Cntrl Dr w/Cover Plate Assy			818906 – SL3131 ADC PH8.4 OPL Control Door Assy		
CHANGE FROM			CHANGE TO		
Qty.	P/N	Description	Qty.	P/N	Description
1	319337	ADC Phase 8.4 Control Board Cover	1	319009	Solaris Control Board Cover
Assembly numbers affected by this change					
819504 – CGS3131 ADC PH8.4 25 Cent Coin Control Door Assembly					
819608 – CGS3131 ADC PH8.4 OPL Control Door with Cover Plate Assembly					
818906 – CGS3131 ADC PH8.4 OPL Control Door Assembly					

Comments: The current control board cover (ADC P/N 319009) is a direct replacement for the previously used cover (ADC P/N 319187 or ADC P/N 319337). Any parts

order placed for the previously used cover (ADC P/N 319187 or ADC P/N 319337) will be cross-referenced and filled with the current cover (ADC P/N 319009).

Soft Start Dip Switch Setting Change

Models Affected: D90, D120, D170 (models with soft start motor control)

Date Implemented: January 17, 2007

Nature of Change: Informational

Due to a series change by the soft start manufacturer, the Dip switch settings now differ. Soft start changed from series A to series B. Dip switch #15 must be in the up "ON" position for the B series to function correctly. All applicable production drawings/wire diagrams have been revised to turn "ON" Dip switch #15. Turning "ON" Dip switch #15 does not have a negative affect on the A series, since ADC does not use the optional auxiliary #2.

Currently ADC has both series A and B in the field. If you have a soft start acting erratically, please confirm series of soft start (on soft start data label) and if series B, Dip Switch #15 must be set to "ON".

Latest Dip Switch Configuration:

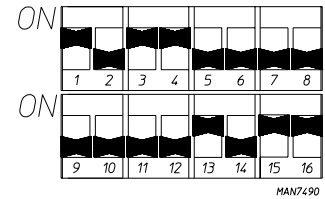

SMC 3 Series B vs. Series A

Question: What are the differences between series A and series B for the SMC 3 product?

Answer: The physical characteristics of the product are the same between series A and series B. The only difference is in the product software.

The SMC 3 series B incorporates new functionality that allows it to be connected in the line configuration (3 lead motor) or in the delta configuration (6 lead motor). This functionality is configured through Dip switch #15. In series A product this Dip switch was used to configure the operation of an optional auxiliary relay (Auxiliary #2). In series B, the operation of the optional auxiliary contacts will be opposite of what is programmed by Dip switch #14.

Part numbers or assembly numbers affected by this change

132275 Soft Start 16A 100-240Vac Control

132276 Soft Start 9A 100-240Vac Control

132277 Soft Start 3A 100-240Vac Control

Comments: This series change also affects all soft starts sold as a parts order, including related upgrade kits.

Returning Warranty Parts to American Dryer Corp.

All dryer or warranty claims or inquires should be addressed to the ADC Warranty Parts Department.

Warranty Manager
Ron Desmarais
Tel.: (508) 678-9000, ext. 158
Fax: 508-324-9449
E-mail: rnd@amdry.com

To expedite processing, the following procedures must be followed. Each part must be tagged with the following information:

- Model number and serial number of the dryer from which part was removed.
- Nature of failure (be specific).
- Date of dryer installation.
- Date of part failure.
- Specify whether the part(s) being returned is for a replacement or a credit.

If a part is marked for a credit, the invoice number covering the purchase of the replacement part must be provided.

Warranty tags (ADC Part No. 450064) are available at "no charge" from ADC upon request.

The company returning the parts must clearly note the complete company name and address on the outside of the package.

All returns must be properly packaged to insure that they are not damaged in transit. Damage claims are the responsibility of the shipper.

IMPORTANT

No replacements or credits will be issued for merchandise damaged in transit.

All returns should be shipped to the ADC factory in such a manner that they are insured and a proof of delivery can be obtained by the sender.

Shipping charges are not the responsibility of ADC. All returns should be "prepaid" to the factory. Any "C.O.D." or "COLLECT" returns will not be accepted.

IMPORTANT

No replacements or credits will be issued if the claim cannot be processed due to insufficient information. The party filing the claim will be notified in writing, either by "FAX" or "CERTIFIED MAIL – Return Receipt Requested," as to the information necessary to process claim. If reply is not received by the ADC Warranty Department within seven days from the FAX/letter date, then no replacement or credit will be issued, and the merchandise will be discarded.

Return Warranty Tag

Your Own Reference Number _____

Date: _____

Company or Individual Returning Part(s) _____

Address _____

City _____

State _____ Zip _____

Telephone No. _____

END USER INFORMATION:

Company Name _____

Contact Name _____

Address _____

City _____

State _____ Zip _____

Telephone No. _____

Item P/N: _____

Part Description _____

Dryer Serial # _____

Nature of Defect _____

RETURNED FOR:

Replacement Credit (Invoice No. _____)

PARTS WARRANTY:

Date of Installation _____

Date of Failure _____

Lint Door/Hatch Change

Nature of Change: Lint (hatch type) door seal sponge gasket has changed from 1/8" to 1/4" to provide for a better seal.

Models Affected: AD-25, AD-30V, AD-78, D40, CG3040

Date Implemented:
December 3, 2006

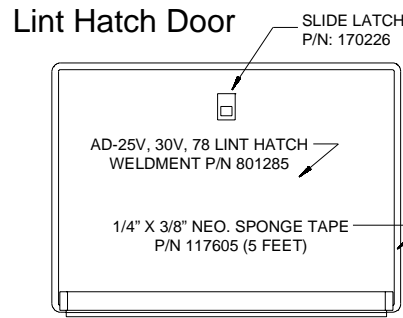

CHANGE FROM			CHANGE TO		
Qty.	P/N	Description	Qty.	P/N	Description
5	117604	1/8" Thick x 3/8" Wide Neo. Sponge Tape	5	117605	1/4" Thick x 3/8" Wide Neo. Sponge Tape
Assembly numbers affected by this change					
802265 – AD-25V, AD-30V, AD-78 Coin Lint Hatch Assembly 802277 – AD-30V, AD-78, D40, CG3040 Drop Lint Door Slide Hatch Assembly					

Comments: Current 1/4" gasket can be used as a replacement in the field for previous models manufactured with the 1/8" gasket.

E-Mail Registration Form

American Dryer Corporation currently distributes the Technical Bulletin updates via e-mail. This technology enables us to send updates to specific individuals who wish to receive the Technical Bulletin. Please feel free to submit as many names for our e-mail file as you wish.

We are asking all of our customers with e-mailing capabilities to fill out the following form with the e-mail addresses of the individual staff members who should receive the Technical Bulletin. After filling out the form below, please fax the form back to American Dryer Corporation at (508) 678-9447 or e-mail the following information to: techregis@amdry.com.

Each Technical Bulletin will be sent as an e-mail attachment. Acrobat Reader must be installed on your computer in order to view and print the file.

Acrobat reader can be downloaded for free from our website:
<http://www.amdry.com/service/techbulletins/index.asp>.

Name: _____

Company _____

Position: _____

E-Mail: _____

Name: _____

Company _____

Position: _____

E-Mail: _____

ADC Publications CD

ADC's current CD-Rom set (2007-1) is available (2 CD set), it includes our most current installation, parts, service, and user's manuals. The CD-Rom set (P/N 882206) can be ordered as a regular parts order at a price of \$21.20 NET each.

Due to the ever-changing nature of computer file formats, the manuals on this CD-Rom are the only manuals available in an electronic format. Other manuals not included on this CD may be purchased directly from ADC in hard copy form at the prevailing cost shown in our Parts Price List. Changes made to the CD-Rom will be listed in future Technical Bulletins. No CD-Rom updates will be available through ADC's website. Only manuals regularly posted on the website will be updated there.

Our Publications CD will be updated quarterly to include changes, updates, and new manuals as they are made available.

NOTE: Once the customer opens the CD envelope and the seal is broken, the CD cannot be returned for credit or refund.

E-Mail Parts Order Shipment Notification

ADC has a system available to notify our customers by e-mail when their parts order is shipped via UPS. However, to do this you MUST ASK for this service and provide an e-mail address at the time the order is placed with our customer service representative. Once the order is shipped by ADC, the automatic UPS shipping notification system will be activated and you will be informed by UPS, via e-mail, of the status of your shipment.

The notification will include the following important delivery information: ship to address; number of packages in shipment; UPS service (next day air, etc.); weight; UPS tracking number; and reference number, which is ADC's acknowledgment number (packing list). Any reply to this notification will not be received by UPS or ADC.

Website Publications

The publications section of our website (<http://www.amdry.com/service/index.asp>) includes a library of all publications available electronically, including Installation, Parts, Service, and User's manuals. Technical Bulletins, Parts Price List, and Warranty information can also be found. The site includes both current production and past production manuals.