

# Technical Bulletin

Number 190

October 14, 2008

## In-Line Water **SERVICE TIP** Connection Inspection

For models manufactured with SAFE or F.S.S., at preliminary installation/start up, and after servicing any SAFE/F.S.S. components, an inspection should be made at the SAFE/F.S.S. dryers water line connections (see illustration) prior to the water solenoid valve to insure that they are no leaks, and that the teflon tape is in place. During the inspection connection points, especially those made of brass, should be inspected for cracks or fractures.

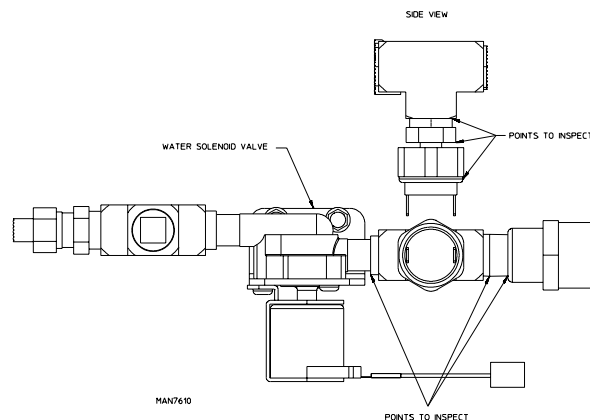

**Often asked questions about the use of Teflon tape**  
**How much Teflon tape should I use?**  
**How many times around should I wrap Teflon tape?**  
**Which direction should Teflon tape be wrapped?**

Start wrapping the male threads at end of the pipe but do not lap over the end. Doing so may result in reduced water pressure or even clogs from bits of the tape that get into the water supply.

- Start with a couple loops around at the end, then wrap all the threads, overlapping half the width of the tape on each wind.
- Wrap in the direction of the threads starting from the end and proceeding toward the length of the pipe.

Wrapping the wrong way may result in the tape coming unwound as the fittings are tightened.

- As you wrap, keep tension on the tape so that it is pulled into the threads.
- If you loosen or disconnect a fitting, remove the old tape and rewrap with a fresh piece.

Caution: Use of PTFE Teflon tape does not guarantee a leak free connection. Always inspect connections, with water pressure, for leaks before sealing them from access.

## Parts Price List

Our current parts price list (ADC P/N 451000) has a September 15, 2008 effective date, and is available to be downloaded for free from our website, [www.amdry.com](http://www.amdry.com). An updated price list will be issued in December. The parts price list is available on our CD (ADC P/N 882206). Printed copies of the current parts price list is available through normal parts channels at a net price of \$12.00 each.

**Updated twice  
a year  
June and December**

### IMPORTANT

- \$ Prices are subject to change without notice. The prices on the invoice many not necessarily be the same as shown on the part price list.
- \$ Formal (written) quotes will be valid for thirty (30) days. When submitting parts orders in which a formal quote was issued, the quotation number must be provided at the time or the quote will not be valid.
- \$ Verbal quotes are not binding and will not be honored.



88 Currant Road  
Fall River, MA  
02720-4781  
Telephone:  
(508) 678-9000  
Fax: (508) 678-9447

### INSIDE

Mid Line Models with Timer Controls Contactor Change .....	2
MDG-31, MLG-33 Tumbler and Motor Change ....	3
Mid Line Motor Contactor Change .....	3
SL-31, SL-3131 Tumbler and Motor Change .....	3
SL31, 3131 50 Hz OPL Front Panel Change .....	3
ADC Factory Rebuilt Computer Boards .....	4
Phase 6 OPL Controller Boards Available Again ...	4
Dryer Serial Number Alpha Date Code .....	4

For more information, visit our website at [www.amdry.com](http://www.amdry.com) or email: [techsupport@amdry.com](mailto:techsupport@amdry.com)

# Mid Line Models with Timer Controls Contactor Change

The 3 phase motor contactor used in the mid line models manufactured with timer controls has changed. This change was implemented on September 3, 2008 and includes all related subassemblies sold as parts orders.

Illustration is for comparison purposes only.

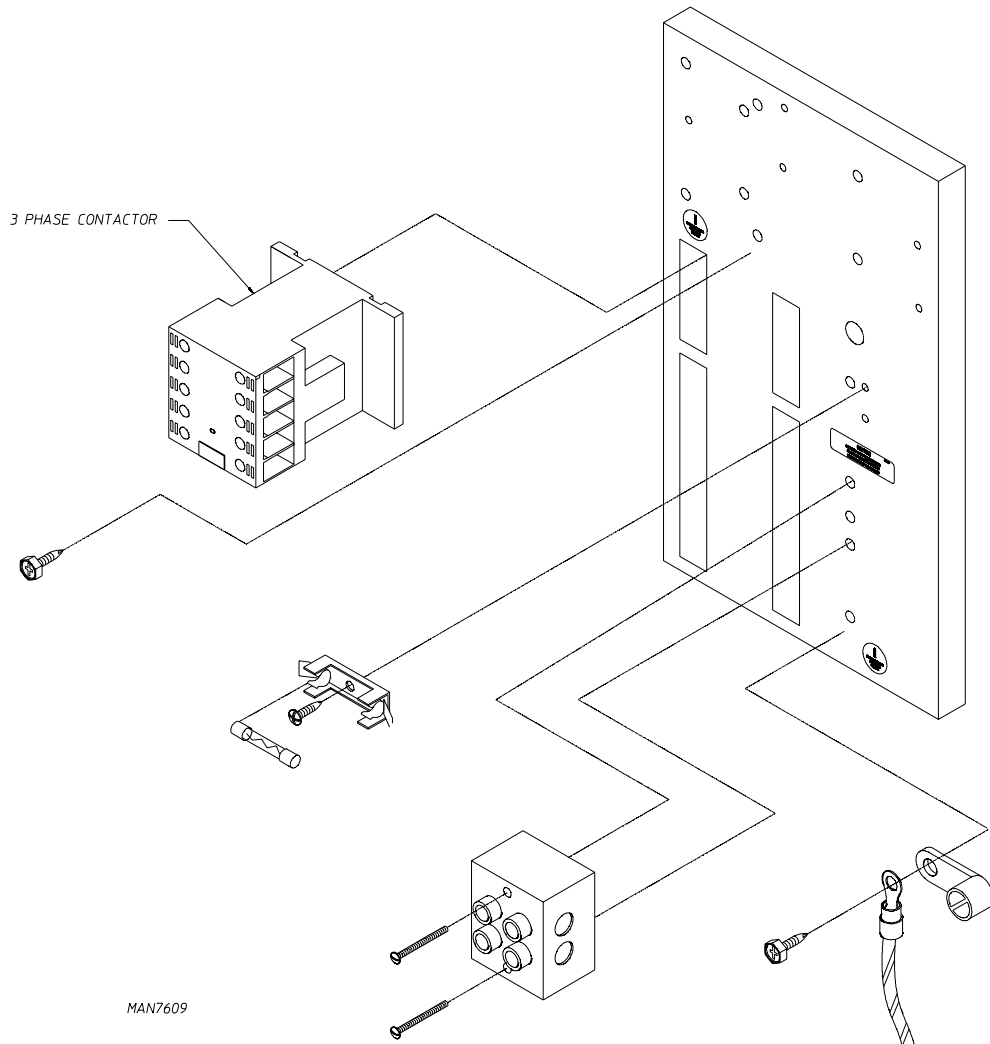

Change From			Change To		
Qty.	Part No.	Description	Qty.	Part No.	Description
1	132445	12 AMP 3PH CONTACTOR 24VAC	1	132514	12 AMP 3PH CONT 24V CTRL K-LINE
1	313999	BACKELECT BOX COMPONENT PLATE	1	322812	BACKELECT BOX COMPONENT PLATE

Important: The two contactors are not interchangeable without modifications.



*Look to ADC when you're looking to outfit your facility with commercial drying products*

# MDG-31, MLG-33 Tumbler and Motor Change

The tumbler used in the models MDG-31 AND MLG-33 (60 Hz models only) has changed. The tumbler/basket has changed from a 4 rib to a 3 rib design. As the result of this change, the motor pulley and related assemblies differ as well.

The 4 and 3 rib tumblers are NOT interchangeable without modifications to the dryer (i.e. motor pulley or motor/w pulley assembly is required).

This change was implemented into production on March 12, 2008.

Change From			Change To		
Qty.	Part No.	Description	Qty.	Part No.	Description
1	818815	SOLID BACK 4 rib TUMBLER ASSY GALV	1	819849	Galv 3 RIB TUMBLER ASSY. tu
1	819425	MOTOR MOUNT ASSY COMP. 4 RIB 60HZ	1	815036	MOTOR MOUNT ASSY. COMPLETE 3 RIB 60HZ
1	887150	60HZ MOTOR W/PULLEY (4 RIB)	1	887196	60HZ MOTOR W/PULLEY 3 RIB

# Mid Line Motor Contactor Change

The 3 phase motor contactor used in the mid line models ... AD-115, 120, 130 and 200 (and related models), has changed. The contactor in question is used mostly in the above mentioned models which have the variable speed option. This change was implemented on September 3, 2008 and includes all related sub assemblies sold as parts orders.

Important: The two contactors are not interchangeable without modifications.

Change From			Change To		
Qty.	Part No.	Description	Qty.	Part No.	Description
1	132445	12 AMP 3PH CONTACTOR 24VAC	1	132514	12AMP 3PH CONT 24V CTRL K-LINE
1	132517	24-48 VAC VARISTOR TESYS			

# SL-31, SL-3131 Tumbler and Motor Change

The tumbler used in the models SL-31 and SL-3131 (60 Hz models only) has changed. The tumbler/basket has changed from a 4 rib to a 3 rib design. As the result of this change, the motor pulley and related assemblies differ as well.

The 4 and 3 rib tumblers are NOT interchangeable without modifications to the dryer (i.e. motor pulley or motor/w pulley assembly is required).

This change was implemented into production on July 18, 2008.

Change From			Change To		
Qty.	Part No.	Description	Qty.	Part No.	Description
1	819398	STAINLESS STEEL 4 RIB TUMBLER ASSEMBLY	1	819850	STAINLESS STEEL 3 RIB TUMBLER ASSEMBLY
1	819425	60HZ MOTOR MOUNT ASSY. 4 RIB COMPLETE	1	815036	60HZ MOTOR MOUNT ASSY. 3 RIB COMPLETE
	887150	60HZ MOTOR W/PULLEY 4 RIB	1	887196	60HZ MOTOR W/PULLEY 3 RIB

# SL31, 3131 50 Hz OPL Front Panel Change

As of July 10, 2008 the 50 Hz OPL version of the SL-31, and SL-3131 front panels have changed. Changes to the panel include wider ducts and the auto cycle moisture sensor has been relocated to the 6 o'clock position. The new panel is a direct replacement for models manufactured with the previous version panel.

Change From			Change To		
Qty.	Part No.	Description	Qty.	Part No.	Description
1	819359	SL3131 FRONT PANEL ASSY WITH AUTO CYCLE	1	818993	SL3131 FRONT PANEL ASSY WITH AUTO CYCLE at 6 o'clock

# ADC Factory Rebuilt Computer Boards

*Get the assurance of a factory rebuilt board!  
Includes upgrades, enhancements and warranty.*

- All boards \$125 (Both Single or Dual Boards)
- Includes return shipping via UPS ground (U.S. Only).  
No service charge for non-repairable boards

**\*\* ADC does NOT repair any Phase 7 or Phase 8 controllers.**

ADC's remanufactured program is for past microprocessor (MP) production controllers. This program requires that the core (failed out of warranty controller) must be returned to ADC first. These remanufactured controllers cannot be purchased through normal parts channels. No customer or reseller can call and place an order for remanufactured controllers. ADC must be in possession of the failed out of warranty controller (core) before any order can be processed. There are no exceptions.

For more details, contact our repair board support at 508-678-900 ext. 130.

## Remanufactured Controllers Available

137050	137077	137095	137122	137153	137172	137190	137240
137051	137078	137096	137123	137154	137173	137191	137241
137052	137079	137097	137124	137155	137174	137192	137251
137053	137080	137098	137125	137156	137175	137193	137300
137061	137081	137101	137126	137157	137176	137194	137301
137062	137082	137102	137128	137158	137177	137195	137302
137063	137083	137103	137130	137159	137178	137196	137303
137064	137084	137105	137131	137160	137179	137199	137304
137065	137085	137106	137133	137161	137180	137213	137917
137066	137086	137108	137135	137162	137181	137216	880771
137067	137088	137109	137136	137163	137182	137219	880776
137068	137089	137110	137138	137164	137183	137222	880810
137069	137090	137115	137139	137165	137184	137225	880811
137072	137091	137116	137140	137166	137185	137227	
137073	137092	137118	137150	137169	137186	137231	
137075	137093	137119	137151	137170	137187	137234	
137076	137094	137120	137152	137171	137188	137237	

## Phase 6 OPL Controller Boards Available Again

Sometime back, the Phase 6 OPL computer system was discontinued from the ADC product line, and parts sales. We now have a Phase 6 controller which works for all Phase 6 OPL applications ... non-Reversing, reversing, with airjet, no airjet etc. This Phase 6 board is ADC part number 137124 can be used as a direct replace-

ment (without dryer modifications) for the part numbers 137122 and 137123.

This is NOT a repaired board, it's a new board from a new vendor, carries our standard parts warranty, and can be purchased through normal ADC parts channels at a price of \$269.44 list each.

## Dryer Serial Number Alpha Date Code

Since 1990, ADC has used an alpha date code at the end of our six digit serial number. This alpha date code, which consists of two letters is a helpful tool in the field for determining the approximate vintage (age) of the dryer. This alpha code is useful when referring to date changes in technical bulletins, parts identification, determining the correct installation and parts manuals for a dryer and warranty verification.

The alpha date code denotes the approximate year and month the dryer was manufactured. The first letter is the year and the second letter is the month. As an example, using the dryer serial number alpha date code legend below, serial number 451154ZM was manufactured in 2001, June and serial number 358222KZ in 1994, December.

### DRYER SERIAL NUMBER ALPHA DATE CODE LEGEND:

B	1990	January
D	1991	February
F	1992	March
H	1993	April
K	1994	May
M	1995	June
Q	1996	July
S	1997	August
U	1998	September
W	1999	October
Y	2000	November
Z	2001	December
A	2002	January
C	2003	February
E	2004	March
G	2005	April
J	2006	May
L	2007	June
N	2008	July
P	2009	August
R	2010	September
T	2011	October
V	2012	November
X	2013	December

### IMPORTANT

This date code is approximate and for reference purposes only. For exact date of manufacture, contact the ADC factory.